



# D-Ring Anchor Plate

Part# P-00720S

SPECIFICATIONS

PAGE 1 OF 1

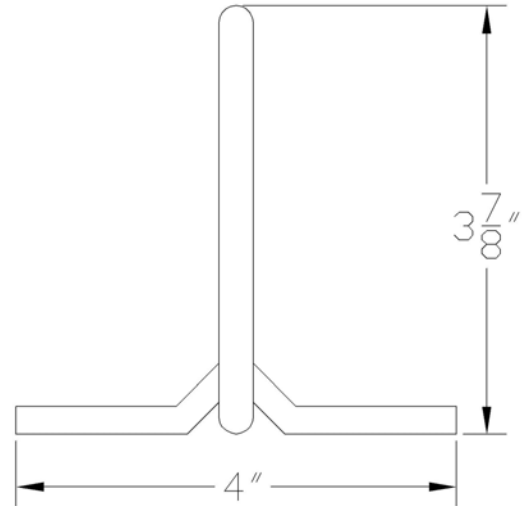
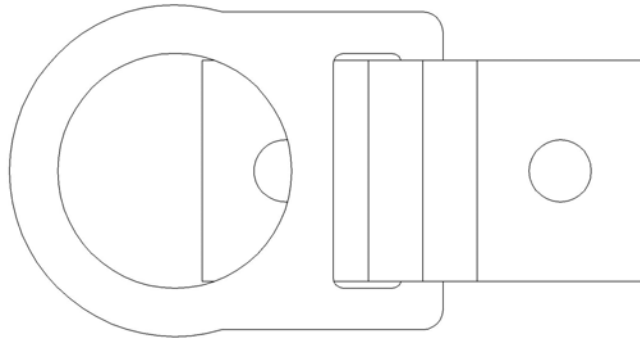

## INSTALLATION INSTRUCTIONS\*\*

**BOLTING TO STEEL:** Use (2) 1/2" Grade 5 or better or 304SS or better bolts of sufficient length that at least one full thread shows beyond the nut after installation.

**BOLTING TO CONCRETE:** Use (2) 1/2" mechanical anchors or (2) 1/2" 304SS threaded rods with chemical anchors. Anchors must maintain a minimum ultimate tension of 5,000lbs/ea.

**WELDING:** 3/16" fillet weld, 1" stitch on ends and sides (total 6 places). Consult AWS welding code to determine proper wire match for welding 304SS anchor plate to material at desired location.

\*\* In all cases it is the responsibility of the end user to ensure the anchorages this anchorage connector will be attached to are able to sustain the maximum rated load of this anchor.

### DESCRIPTION

The D-Ring anchor plate is designed to be a permanent or temporary anchorage point for a single worker, or for horizontal lifelines that limit the forces at the connection point to 2500lb or less. Load may be applied in all directions.

### GENERAL SPECIFICATIONS

tem	Description	Tested At
Plate	1/4" 304 Stainless Steel	N/A
D-Rings	Stamped Plate 304 Stainless Steel	5,000 lb
Capacity—1 worker, max weight 310lbs including tools and equipment		
Break Strength—Min 5,000 lbs.		
Weight—2 lbs		
Technical References: Meets OSHA 1926 Subpart M, ANSI Z359-2007		